

# WPM

## Peripheral Type of Pumps



### FEATURES

- Close-coupled peripheral pumps with turbine impeller
- Maximum liquid temperature: 60°C
- Maximum ambient temperature: 40°C
- Protection Class IP44
- Insulation Class: F
- With thermal overload protection (for 1 ph)
- Compact design

### APPLICATIONS

It is for clean liquids without abrasives, suspended solids, explosive, non-aggressive for the pump materials.

It is for small household systems and simple industrial applications, domestic booster system. The pump should be installed in enclosed environment or at least sheltered from inclement weather.

# WPM

## Peripheral Type of Pumps

### Performance Table

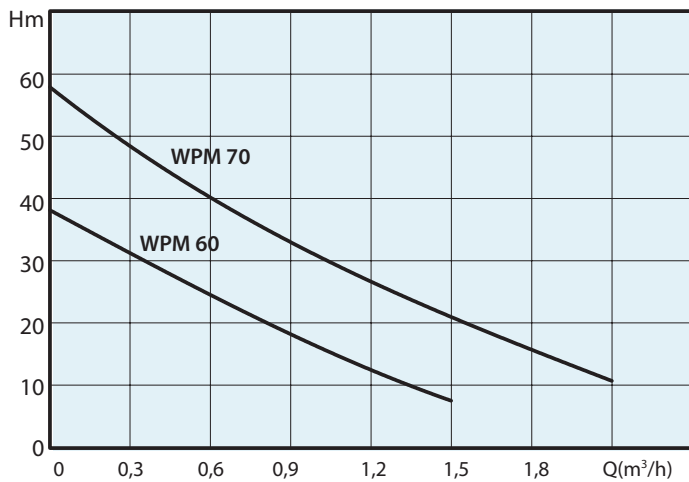

| Part            | Material     |
|-----------------|--------------|
| Pump Body       | Cast Iron    |
| Impeller        | Brass        |
| Mechanical Seal | SIC / Carbon |
| Support         | Aluminum     |
| Rotor           | AISI 304     |
| Cooling Fan     | Noryl        |
| Fan Cover       | Iron         |

| Type   | P2   |     | 1 Ph 230 V | Capacitor |     | l/min<br>Q m³/h | 0  | 5   | 10  | 15   | 20   | 25   | 30   | 35  | Weight<br>kg |
|--------|------|-----|------------|-----------|-----|-----------------|----|-----|-----|------|------|------|------|-----|--------------|
|        | kW   | HP  | A          | μF        | V   |                 | 0  | 0,3 | 0,6 | 0,9  | 1,2  | 1,5  | 1,8  | 2,1 |              |
| WPM 60 | 0,37 | 0,5 | 2,5        | 8         | 450 | H m             | 38 | 31  | 25  | 17,5 | 13   | 7,5  | -    | -   | 6            |
| WPM 70 | 0,6  | 0,8 | 3,8        | 12        | 450 |                 | 58 | 48  | 40  | 33   | 27,5 | 20,5 | 15,5 | 11  | 9,5          |

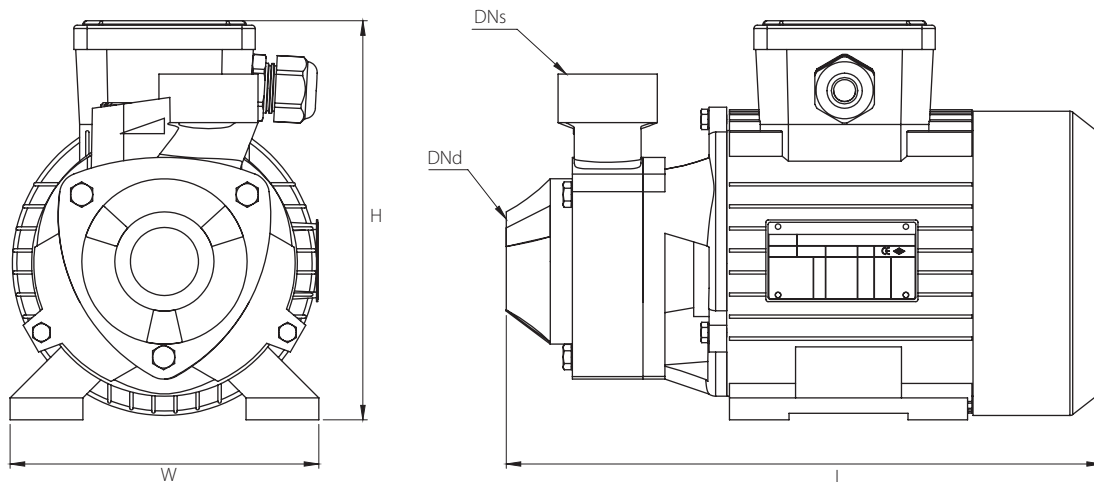

| Model  | DNs | DNd | W   | L   | H   |
|--------|-----|-----|-----|-----|-----|
| WPM 60 | 1"  | 1"  | 150 | 300 | 200 |
| WPM 70 | 1"  | 1"  | 150 | 300 | 200 |